

Parts List



File No.

Air Conditioner

OUTDOOR UNIT
CMH2472

Model No.	Prod.Code	Volt-Phase-Hertz
CMH2472	1 852 330 31	230-208-1-60

REFERENCE No.PL 706298

CMH2472
OUTDOOR UNIT

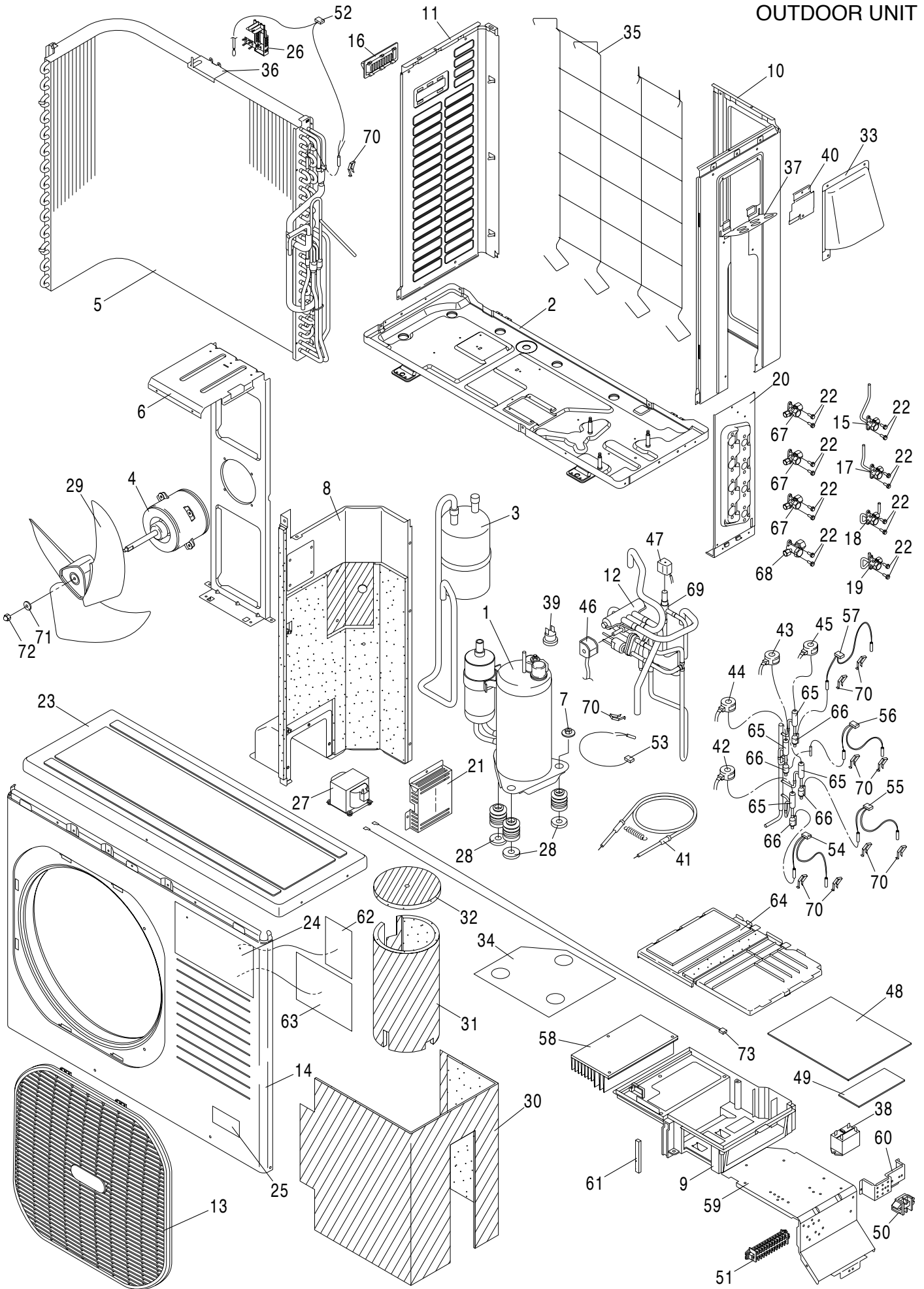

ATTENTION !

To ensure correct parts supply, please let us know followings,
when you make service parts order:

1.Part No. 2.Description 3.Q'ty 4.Volts-Hz-Ph 5.Product Model No.

CMH2472
OUTDOOR UNIT

Key No.	Part No.	Description	Q'ty	Reference No.
* 1	623 192 4016	Comp Sub Ass'y 5KD240XAB21	1	852-0-4526-34100
2	623 191 8039	Bottom Plate Ass'y	1	852-0-2202-79411
3	623 192 4009	Accumulator Ass'y	1	852-0-4511-31400
* 4	623 191 5427	Fan Motor SIC-71FW-D490-1	1	1FA-4-M4A0-10400
5	623 192 3996	Heat Exch Cond Ass'y	1	852-0-4119-19100
6	623 191 7810	Mounting Plate, Fan Motor	1	852-2-2354-31410
7	623 029 6534	Nut Special Ass'y	3	851-0-2395-10501
8	623 193 1823	Partition Plate Ass'y	1	852-0-2209-40910
9	623 191 7230	Elec.Component Box	1	852-2-5307-70601
10	623 193 1854	Side Panel	1	852-2-1114-42311
11	623 191 7865	Side Panel	1	852-2-1114-41311
* 12	623 191 7445	Solenoid Valve Ass'y STF-02U2G	1	852-0-4509-22800
13	623 191 7858	Guard	1	852-2-1321-24211
14	623 191 7841	Front Panel	1	852-2-1118-24711
15	623 192 4368	Valve Ass'y 1/4"	1	852-0-4515-43900
16	623 191 7186	Handle	1	852-2-2303-17811
17	623 192 4092	Valve Ass'y 1/4"	1	852-0-4515-44000
18	623 192 4085	Valve Ass'y 1/4"	1	852-0-4515-44100
19	623 192 4078	Valve Ass'y 1/4"	1	852-0-4515-44200
20	623 193 1922	Support Valve	1	852-2-2222-38311
21	623 191 7421	Cover Plate	1	852-2-5315-49101
22	623 090 6907	Deltite Screw	16	3-9201-61601
23	623 191 7933	Top Plate Ass'y	1	852-0-1103-23210
24	623 192 4047	Mark	1	852-2-1316-44002
25	623 161 1497	Label	1	854-2-1358-95900
26	623 171 9278	Mounting Thermostat	1	852-2-5303-24501
* 27	623 191 7902	Reactor R9020A-TE-COV	1	1FA-4-L5C0-13500
28	623 191 5618	Cushion Rubber	3	852-2-2390-30800
29	623 191 5458	Propeller Fan	1	852-2-2502-20100
30	623 192 4115	Insulation	1	852-2-2476-69300
31	623 192 4108	Insulation	1	852-2-2476-71900
32	623 191 5632	Insulation	1	852-2-2476-72000
33	623 191 7896	Cover Ass'y	1	852-0-2309-25100
34	623 191 5526	Sheet	1	852-2-5328-50000
35	623 191 5557	Guard Ass'y	1	852-0-1111-23801
36	623 191 7919	Mounting Plate	1	852-2-2385-15811
37	623 193 1939	Conduit Plate	1	852-2-1319-44900
* 38	623 172 7730	Power Relay EL1U	1	1FA-4-S2A0-10000
39	623 192 4139	Thermistor Ass'y	1	8FA-0-5155-00600
40	623 193 1878	Mounting Plate	1	852-2-2385-17811
* 41	623 193 2110	Heater K SP4407Q-09	1	8FA-0-5255-03400
* 42	623 192 4184	Magnetic Coil UKV-A014 5P A-MV	1	8FA-0-5251-15200
* 43	623 192 4177	Magnetic Coil UKV-A006 5P B-MV	1	8FA-0-5251-15300
* 44	623 192 4160	Magnetic Coil UKV-A007 5P C-MV	1	8FA-0-5251-15400
* 45	623 192 4399	Magnetic Coil UKV-A008 5P D-MV	1	8FA-0-5251-15500
* 46	623 191 8046	Magnetic Coil STF-01AQ503UA1	1	8FA-0-5251-14600
* 47	623 193 2103	Magnetic Coil VPV-MOAQ533UB1	1	8FA-0-5251-14700
* 48	623 193 2134	Circuit Board Ass'y CB-CMH2472	1	8FA-0-5181-19900
* 49	623 192 4405	P.C.B. Ass'y POW-CMV4S2	1	8FA-0-5178-58000
* 50	623 160 7445	Terminal Base JTU30-2U	1	1FA-4-J3A0-13300

NOTE: Metal and plastic parts will be supplied basically with necessary heat insulation pads or packing. Each key number with an asterisk (*) means the recommended service parts.

ATTENTION !

To ensure correct parts supply, please let us know followings,
when you make service parts order:

1.Part No. 2.Description 3.Q'ty 4.Volts-Hz-Ph 5.Product Model No.

CMH2472
OUTDOOR UNIT

Key No.	Part No.	Description	Q'ty	Reference No.
* 51	623 193 1953	Terminal Base KTU15N-12J	1	1FA-4-J3A0-26600
* 52	623 192 4245	Thermistor Ass'y K TKS292B/295B	1	8FA-0-5259-16700
* 53	623 192 4238	Thermistor Ass'y K TKS293B	1	8FA-0-5259-16900
* 54	623 192 4221	Thermistor Ass'y K TKS292B/292B	1	8FA-0-5259-17400
* 55	623 192 4214	Thermistor Ass'y K TKS292B/292B	1	8FA-0-5259-17500
* 56	623 192 4207	Thermistor Ass'y K TKS292B/292B	1	8FA-0-5259-17600
* 57	623 192 4412	Thermistor Ass'y K TKS292B/292B	1	8FA-0-5259-17700
58	623 190 7538	Cooler A6063S-T5	1	852-2-4127-24201
59	623 191 7346	Mounting Plate	1	852-2-2385-15601
60	623 193 1915	Mounting Plate	1	852-2-2385-15701
61	623 191 7292	Packing	1	852-2-2380-98210
62	623 192 6119	Elec. Wiring Diagram	1	8FA-2-5257-68500
63	623 193 2141	Elec. Wiring Diagram	1	8FA-2-5257-59300
64	623 191 7353	Cover,Elec.Component Box Ass'y	1	852-0-5302-30700
* 65	623 170 4267	Solenoid Control Valve UKV-18D13	4	854-2-4548-15000
66	623 155 2424	Strainer Ass'y	4	852-0-4506-19500
67	623 192 4313	Valve Ass'y 3/8"	3	852-0-4518-20700
68	623 192 4429	Valve Ass'y 1/2"	1	852-0-4522-20100
* 69	623 193 2127	Solenoid Valve Ass'y VPV-603DU	1	852-0-4509-23000
70	623 148 5876	Mounting Thermostat	10	852-2-5303-22401
71	638 004 7574	Washer	1	3-9021-03300
72	638 012 6705	Funa 6 SUS305	1	3-9275-06010
* 73	623 192 4290	Wire Ass'y CN-REACTOR	1	8FA-0-5285-65200

NOTE: Metal and plastic parts will be supplied basically with necessary heat insulation pads or packing. Each key number with an asterisk (*) means the recommended service parts.

For Parts or Service Contact

SANYO Fisher Service Company
A Division of SANYO North America Corporation
1165 Allgood Road, Suite 22, Marietta, GA 30062 U.S.A.

Sanyo Canada Inc.
1-300 Applewood Crescent, Concord, Ontario, L4K 5C7, CANADA
-4- 3/06 Printed in Japan